

TREE COMMITTEE AGENDA REPORT

SUBJECT REQUEST FOR THE REMOVAL OF TWO (2) EUCALYPTUS NICOLII (NICHOL'S WILLOW-LEAFED EUCALYPTUS) TREES LOCATED AT 2475 MEADOW STREET (TREE-0805-2024)

FROM: Walter Gault, City Arborist
Phone Number: (805) 781-7578
Email: wgault@slocity.org

APPLICANT: Wesley Thompson

RECOMMENDATION

Review the proposed tree removal application for consistency with the Municipal Code Section 12.24.090(E) and provide a recommendation to the Community Development Director.



Figure 1: View of the Eucalyptus trees (on left) from Meadow St.

1.0 APPLICATION DESCRIPTION

Wesley Thompson, the applicant, has requested the removal of two (2) *Eucalyptus nicolii* (Nichol’s Willow-leaved Eucalyptus) in the backyard at 2475 Meadow Street per Municipal Code Section 12.24.090.E(3) related to property owner convenience. The applicant would like to remove the trees and replace them with five (5) 15-gallon box trees onsite, including Trumpet Trees, Ginkgo or other species to the satisfaction of the City Arborist.

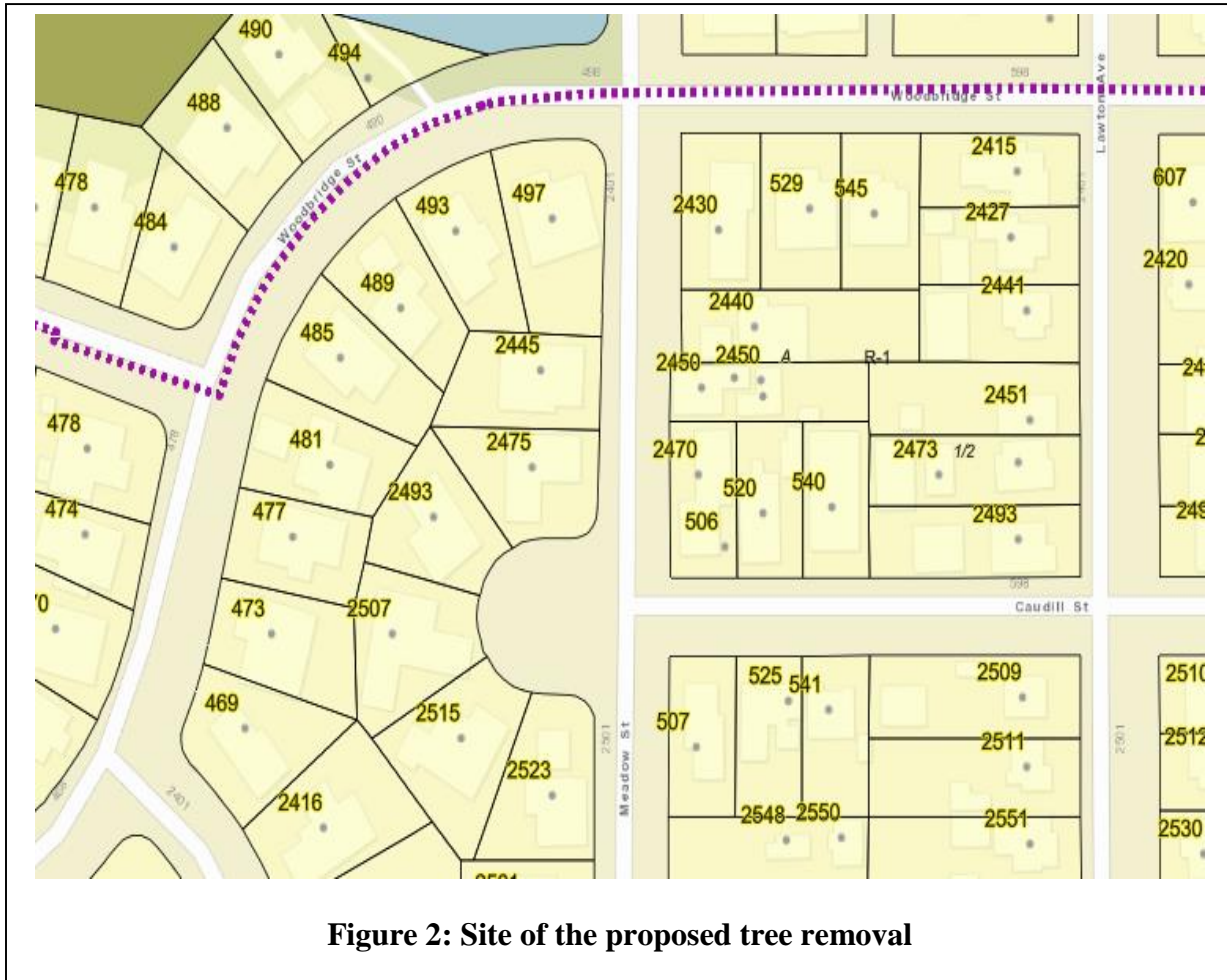

Figure 2: Site of the proposed tree removal

2.0 COMMITTEE PURVIEW

The Tree Committee’s role is to review the removal request in accordance with the process set forth in San Luis Obispo Municipal Code (SLOMC) [Chapter 12.24](#), specifically Section [12.24.090\(E\)\(3\)](#). This code section utilizes the process set forth in [subsection F\(2\)](#), the relevant additional application requirements in [subsection \(D\)\(2\)](#) and the criteria set forth in [subsection \(G\)](#).

3.0 TREE REGULATIONS

Criteria for Convenience Tree Removal Applications.

SLOMC §12.24.090 subsection (E)(3) requires review by the Tree Committee using the criteria set for in SLOMC §12.24.090(G). Applicable criteria are provided in italics below and followed by a description of the proposed tree removals as it relates to that criterion.

- *(G)(1). Size of Tree. The scale of the tree shall be considered, as well as the size of the tree's canopy. Larger, more visually prominent trees may have a higher preservation priority than smaller, less visually prominent trees.*

The trees proposed for removal are large and visually prominent in the neighborhood.

- *(G)(2). Location of Tree on Private Property. The location of the tree on private property shall be considered. Trees located in a private rear yard, which are not highly visible from the public right-of-way, may have a lower preservation priority than trees with a high visual impact to the neighborhood.*

The tree proposed for removal is located in the backyard, but it is also highly visible from the public right of way.

- *(G)(3). Species of Tree. Native trees shall have a higher preservation priority than non-native trees.*

The trees proposed for removal are non-native.

- *(G)(4). Forestry Best Practice. The number of healthy trees that a given parcel of land will support shall be considered, and whether removal would enhance the health or survival of remaining trees. Applications that increase biodiversity of native trees and tree age distribution within a given area are preferred.*

The removal and replanting plan would increase the biodiversity of the urban forest and tree age distribution.

- *(G)(6). Compliance with Subsection J of This Section Regarding Compensatory Plantings. The approving authority may consider an application proposal to provide compensatory plantings in excess of required minimums in evaluating this criterion.*

The applicant is proposing to replant five (5) trees in place of two tree removals.

- *(G)(7). Heritage Trees. Heritage trees have the highest preservation priority.*

Trees are not heritage trees.

4.0 ACTIONS

- 4.1** Recommend findings of consistency with the Tree Regulations. An action recommending approval of the application based on consistency will be forwarded to the Community Development Director for final action. This action may include recommendations regarding the compensatory replanting plan with size and species of tree.
- 4.2** Recommend findings of inconsistency with the Tree Regulations. An action recommending denial of the application should include findings that cite the basis for denial and should reference inconsistency with the General Plan, Tree Regulations, or other policy documents.
- 4.3** Continue the project to a hearing date certain, or uncertain. An action continuing the application should include direction to the applicant and staff on pertinent issues.

5.0 ATTACHMENTS

A - 2475 Meadow Tree Removal Application